I space brain laboratory



cycle Towards a cosmomorphic world **A**

Co-founded in 2009 by artist Ann Veronica Janssens and Nathalie Ergino, director of the Institute for Contemporary Art (IAC), the space brain Laboratory investigates theoretical and practical research that allow for the interconnection of space, time, body and brain.

In the light of both recent-day scientific achievements -in neurosciences, astrophysics, anthropology, biology, geology, etc)- and the reassessment of practices such as hypnosis, shamanism and animism, the space brain Laboratory offers itself, from the perspective of artistic experimenting, as a gathering point for researchers and artists willing to share intuition as their driving force, collective vision as their common ground, and exchange as their working method.

Transdisciplinary by nature, the Lab evolves on a gradual scale, in various stages. These stages make up so many investigative units, and may assume various forms, such as workshops, lectures, or a particular focus on a body of works, whether in-site (*in situ*) or off-site (*ex situ*).

**INSTITUT
D'ART CONTEMPORAIN
Villeurbanne/Rhône-Alpes**

11 rue Docteur Dolard
69100 Villeurbanne
France

t. +33 (0)4 78 03 47 00
f. +33 (0)4 78 03 47 09
www.i-ac.eu

C

From 2009 to 2016 (Stations 1 to 9), the Laboratoire offered multiple approaches to the space as a potential extension of the eye, brain, and body. It was mainly the mechanisms of perception that were studied, whether it be spatialisation, immersion, loss of bearings, or modified states of consciousness.

Redefinitions of our relationship to space and sensitive conditions for experiencing the world were thereby identified.

As of Station (1)0 in October 2016, the Laboratoire launched a new cycle of research entitled "Towards a Cosmomorphic World" in order to envisage human and non-human interrelations with the environment, in a context of profound biological, geological, and climatic upheaval, and updated scientific research. The field of exploration thus extends to the organic connections between living creatures and their porosity with a milieu, in order to comprehend a new mode of coexistence.

The dualistic principles of the Western approach separating human being from nature, opposing matter and spirit, innate and acquired, thus gives way to a cosmological model, a vision of the world that is no longer anthropomorphic, but cosmomorphic.

(A) LIBRARY

Please refer to the Bibliography for a list of publications and periodicals (on-site consultation)

→ **Monographic works** arranged in alphabetical order of authors' names

→ **Theoretical works** arranged in alphabetical order of authors' names

→ **Collective works** arranged in publishing dates

→ **Periodical** arranged in alphabetical order of magazines' names

(B) WORKS

B1. Tony Di Napoli, *Lithophones*, 2016
Sound performance of Thursday 6th of October 2016, in the context of the launching of programme / *Towards a cosmomorphic world*

B2. Pedro Neves Marques, *YWY, a androïde* [YWY, the Android] (Film still), 2017
4K video converted in HD video, colors, sound. Work for study, Station 15, *Become Flesh chair, How to change paradigms in Englanted worlds ?*, Saturday 6th of July 2019 at frac île-de-france - le Château, Rentilly

B3. Kate Newby, *Wild Was the Night*, 2019
Exhibition *OTIUM #4* from 29th of May to 11th of August 2019

B4. Ann Veronica Janssens, *Untitled (Prism)*, 2013
Crystal prism integrated into double-glazed window, room 8, IAC
Exhibition *Ann Veronica Janssens : mars*, from 24th of March to 7th of May 2017

B5. Matt Mullican, *The IAC Mural*, June 15 2010, 2010
Mural painting, 9 x 15 m, IAC's garden

(C) AUDIOVISUAL & INTERNET

Site : <http://laboratoireespacecerveau.eu>

All the lectures, study days, updated references and other documents can be downloaded from the site devoted to the Laboratory.

[4 DOCUMENTARY FILMS, Arte Distribution](#)
[In partnership with Arte Distribution](#)

→ ***Blob, un génie sans cerveau*, 2019**
Director : Jacques Mitsch ; Hauteville Productions. (Upcoming)

Neither plant, nor animal, nor mushroom, the blob defies the canons of biology. It's enough to disconcert the scientific community! This unicellular organism has existed for over a billion years, well before the emergence of animals or plants.

→ *Déchiffrer la conscience, voyage dans l'étoffe de nos pensées, 2016*

Director : Cécile Denjean ; Production Scientifilms, Arte France.

What is awareness ? Where do our thoughts come from ? What are the links between matter and spirit? Nowadays, nobody knows it. The Human awareness, that little inner voice saying « I » and who tells us about the world, is one of the modern science's greatest mysteries.

→ *Le cerveau en miroir, 2008*

Director : Philippe Baylaucq ; Production Arte France.

Our exploration leads towards the « depths » of the brain and to the sources of awareness to give a surprising overview of thought process.

→ *Printemps sous surveillance : quand les scientifiques décryptent la nature, 2012*

Director : François-Xavier Vives ; Production Arte France, Camera Lucida Productions.

What is a season? Although we've been to the Moon and we're exploring the farthest reaches of the universe, do we really know our most familiar environment?

[PODCASTS RADIO SHOWS France Culture](#)
[In partnership with France Culture](#)

All the radio programmes can be listened and podcasted on franceculture.fr

→ *LSD, La série documentaire de Perrine Kervran*

**Bienvenue dans l'Anthropocène ! (1/4)
Où le vivant s'effondre**

With Bernie Krause, bio-acoustician, Catherine Larrère, philosopher, David Mouillot, environmentalist, marine ecology specialist, François Sarrazin, environmentalist, scientific director of the Foundation for researcher on biodiversity (FRB), Gilles Bœuf, environmentalist, former president of National Museum of Natural History (MNHN), Gilbert Cochet, naturalist, president of Scientific Council of the Gorges de l'Ardèche, Philippe Descola, anthropologist, Vincent Devictor, environmentalist, epistemologist, Vincent Bretagnolle, environmentalist, agronomist, director of the Chizé Centre for Biological Studies

(CEBC). A series of Tao Favre, conducted by Gaël Gillon.

With the collaboration of Annelise Signoret.

Programme broadcast on 7 January 2019.

→ *LSD, La série documentaire de Perrine Kervran*

**Bienvenue dans l'Anthropocène ! (2/4)
L'écologie ou la mort**

Alexandre Genin, environmentalist, Catherine Larrère, philosopher, Charles Hervé-Gruyer, farmer, Dominique Bourg, philosopher, Marc-André Selosse, microbiologist, Sonia Kefi, environmentalist, Vincent Devictor, environmentalist, epistemologist and Vincent Bretagnolle, environmentalist, agronomist, director of Centre d'Etudes Biologiques de Chizé (CEBC).

A series of Tao Favre, realized by Gaël Gillon.

With the collaboration of Annelise Signoret.

Programme broadcast on 8 January 2019.

→ *LSD, La série documentaire de Perrine Kervran*

**Bienvenue dans l'Anthropocène ! (4/4)
Des mondes à composer**

Alessandro Pignocchi, intermittent development protester, John Jordan, development protester, Muriel Fifils, founder and director of Caminando primary school, Philippe Descola, anthropologist, Thierry Geffray, farmer and Virginie Maris, researcher in environmental philosophy.

A series of Tao Favre, realized by Gaël Gillon.

With the collaboration of Annelise Signoret.

Programme broadcast on 10 January 2019.

→ *La Conversation scientifique par Etienne Klein*

Comment composer avec le monde « non-humain » ?

With Philippe Descola, anthropologist, professor to the Chair in Anthropology of Nature at the Collège de France and director Laboratory of Social Anthropology (LAS).

Programme broadcast on 3 January 2015.

Space of the Laboratory

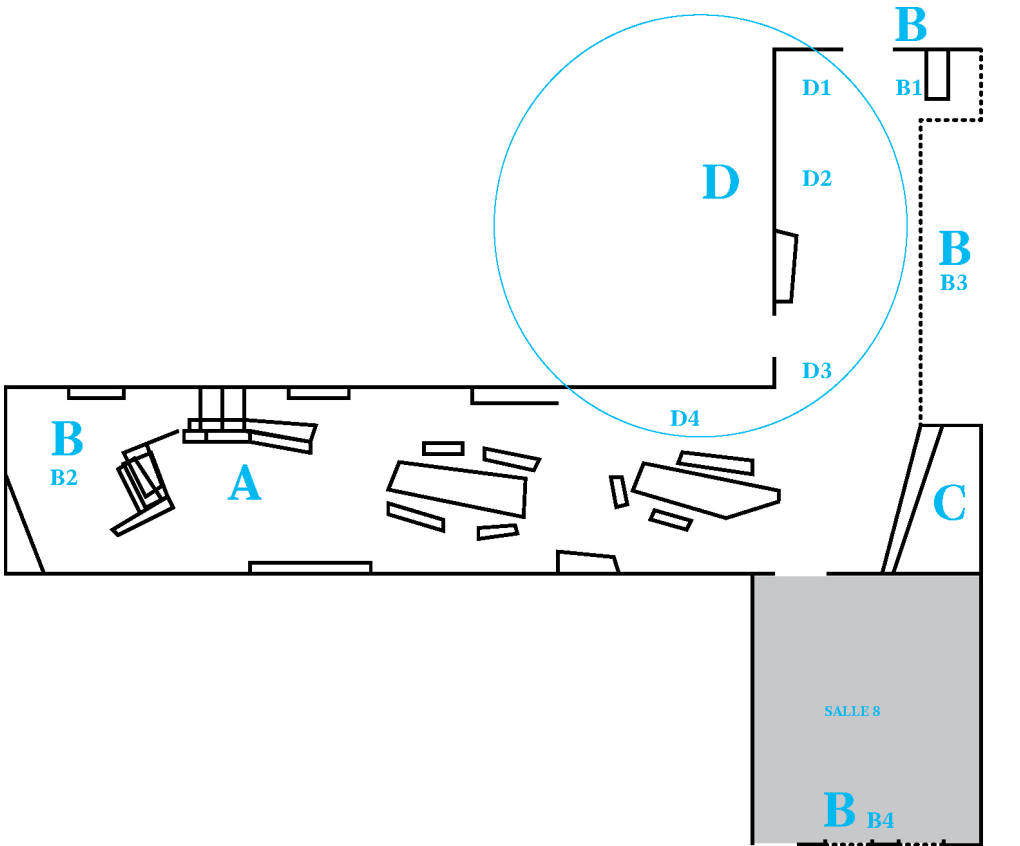

A. Library

B. Works

→ B1 Tony Di Napoli

→ B2 Pedro Neves Marques

→ B3 Kate Newby

→ B4 Ann Veronica Janssens

→ B5 Matt Mullican

C. Audiovisual

D. Visual documentation

→ D1

→ D2

→ D3

→ D4

ROOM 8.

station 16

Metamorphosis and contamination, the permanence of change

Within the context of the 15th Lyon Biennale

(refer to the guide book of the Station 16)

B B5

(D) Visual documentation

Works under study 2009-2019

→ D1. Dan Graham (1) → Larry Bell (18)

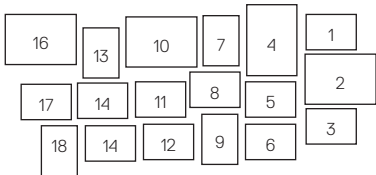

→ D2. Antony McCall (19) → Ernesto Neto (94)

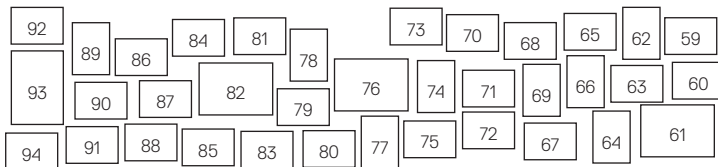
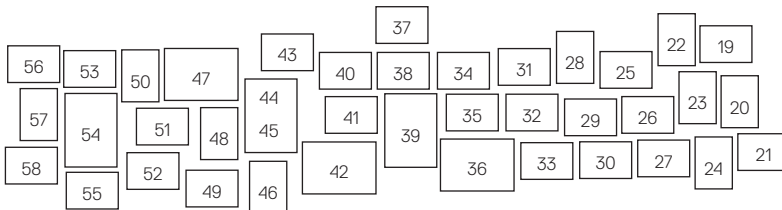

→ D3. Philippe Parreno (95) → Ann Veronica Janssens (100)

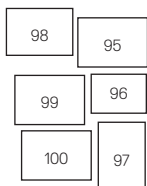

→ D4. Jef Geys (101) → Maria Laet (147)

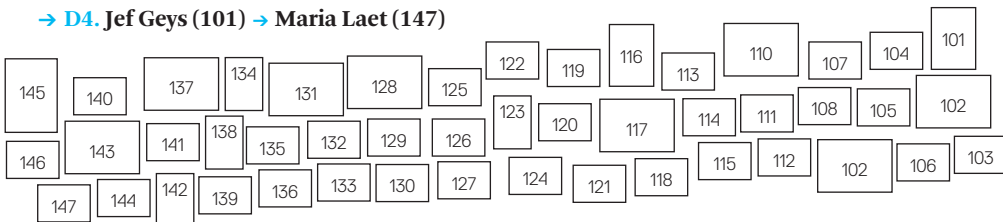

(D) VISUAL DOCUMENTATION

Index of the reproduced works + display schema and numbering :
Name of the artist, title of the work, date of the work. [Labo station number or exhibition]

D1

1. Dan Graham, *Project for Slide Projector, 1966-2005* [*Collection(s) 08*, 2008]
2. Vincent Lamouroux, *AR. 07*, 2008 [*Fabricateurs d'espaces*, 2008-2009]
3. Ann Veronica Janssens, *Cabinet (en croissance)*, 2001-2008 [*Collection(s) 08*, 2008]
4. Anthony McCall, *Between You and I et autres films de lumière solide*, 2006-2007 [*Anthony McCall*, 2006-2007]
5. Raymond Hains et Jacques Villeglé, *Pénélope*, 1950-1980 [*Distorsions*, 2006]
6. Rita McBride, *National Chain*, 1997 [*Fabricateurs d'espaces*, 2008-2009]
7. Philippe Decrauzat, *One Two Three Four Five & Can I Crash Here*, 2005 [*2006 Immersions 2016*, 2016]
8. Guillaume Leblon, *Four Ladders*, 2008 [*Fabricateurs d'espaces*, 2008-2009]
9. Laurent Grasso, *Echelon*, 2007 [*Collection(s) 08*, 2008]
10. Ann Veronica Janssens, *Pink and Yellow*, 2000-2014 [*Collection à l'étude à Villeurbanne*, 2014]
11. Ann Veronica Janssens, *Prototype de brouillard coloré*, 2009 [Station 1, 2009]
12. Robert Irwin, *Light and Space*, 2007 [Station 1, 2009, documentation]
13. Lucio Fontana, *Ambiente spaziale*, 1967 [Station 1, 2009]
14. Nicolas Schöffer, *Kyldex 1*, 1973 [Station 1, 2009]

15. Carlos Cruz-Diez, *Chromosaturation du rouge et du bleu*, 1965 [Station 1, 2009]

16. Julio Le Parc, *Continuel-lumière cylindre*, 1962 [Station 1, 2009]

17. Robert Morris, *Cloud Gardens*, 1992 [Station 1, 2009, documentation]

18. Larry Bell, *Untitled*, 1967 [Station 1, 2009, documentation]

D2

19. Anthony McCall, *Conical Solid*, 1974 [Station 1, 2009]

20. François Morellet, *Boîte à flash*, 1964 [Station 1, 2009]

21. Thomas Wilfred, *Quatre moments de Unfolding, Opus 127 (détail)*, 1933-1943 [Station 1, 2009, documentation]

22. Matt Mullican, *IRM du cerveau de Matt Mullican en état normal et sous hypnose* [Station 3, 2010]

23. Brion Gysin, *Dreamachine*, 1961-1979 [Station 1, 2009, documentation]

24. James Turrell, *Alta (White)*, 1967 [Station 1, 2009, documentation]

25. Brion Gysin, *Dreamachine*, 1961-1979 [Station 4, 2010]

26. Douglas Wheeler, *RM 669*, 1969 [Station 1, 2009, documentation]

27. Paul Sharits, *N.O.T.H.I.N.G.*, 1968 [Station 1, 2009]

28. Richard Venlet, *Sans titre*, 2001 [Station 2, 2010]

29. Matt Mullican, *The IAC Mural, 15 June 2010*, 2010 [*Matt Mullican : 12 By 2*, 2010]

30. Pierre Schaeffer, *L'œuvre musicale*, 1998 [Station 1, 2009]

31. Joachim Koester, *Tarantism*, 2007 [*Joachim Koester: Of Spirits and Empty Spaces*, 2011-2012]

- 32. Gianni Colombo, *Spazio Elastico*, 1967** [Station 1, 2009, documentation]
- 33. La Monte Young, *Marian Zazeela, Dream House*, 1990** [Station 1, 2009, documentation]
- 34. Bernard Bazile, *Brilliance*, 2011** [Station 6, 2011]
- 35. Matt Mullican [Matt Mullican : 12 By 2, 2010]**
- 36. Matt Mullican [Matt Mullican : 12 By 2, 2010]**
- 37. Joachim Koester, *Message From Andrée*, 2005 [Joachim Koester: Of Spirits and Empty Spaces, 2011-2012]**
- 38. Films d'Éric Duvivier, 1961-1967** [Station 7, 2012]
- 39. Gianni Colombo, *Spazio Elastico*, 1967** [Station 5, 2011]
- 40. Joachim Koester, *The Hashish Club*, 2009 [Joachim Koester: Of Spirits and Empty Spaces, 2011-2012]**
- 41. Yann Chateigné, Documentation hypnagogique rassemblée, cassette, 2012** [Station 7, 2012]
- 42. Joachim Koester, *Demonology*, 2010** [Joachim Koester: Of Spirits and Empty Spaces, 2011-2012]
- 43. Julien Discrit, *Carte mémoire (Los Angeles)*, 2010 [Erre, variations labyrinthiques, Station 8, 2012]**
- 44/45. Agnes Denes, *Snail Pyramid-Study for Self-Contained, Self-Supporting City Dwelling – A Future Habitat*, 1988, et *Snail People, The vortex*, 1989 [Erre, variations labyrinthiques, Station 8, 2012]**
- 46. Matt Mullican, *Two into One becomes Three (ébauche)*, 2011 [Erre, variations labyrinthiques, Station 8, 2012]**
- 47. Robert Smithson, *Spiral Jetty*, 1970 [Erre, variations labyrinthiques, Station 8, 2012]**
- 48. Richard Long, *Untitled*, 1994 [Erre, variations labyrinthiques, Station 8, 2012]**
- 49. Saul Bass, Générique du film *Vertigo [Sueurs froides]* d'Alfred Hitchcock sorti en 1958 [Erre, variations labyrinthiques, Station 8, 2012]**
- 50. Robert Morris, *Untitled*, 1974 [Erre, variations labyrinthiques, Station 8, 2012]**
- 51. Julio Le Parc, *Continuel lumière cylindre*, 1962 [Erre, variations labyrinthiques, Station 8, 2012]**
- 52. Mona Vatamanu & Florin Tudor, *Land Distribution*, 2012 [Dimensions variables, 2012]**
- 53. Paul Sharits, *Analytical Studies n°2: Unframed Lines*, 1976 [Laboratoire espace cerveau : retour sur Gianni Colombo et Paul Sharits, 2016]**
- 54. Berdaguer & Péjus, *Arbres*, 2012** [Berdaguer & Péjus : Insula, 2012]
- 55. Toba Khedoori, *Untitled (Black Windows)*, 2006 [Erre, variations labyrinthiques, Station 8, 2012]**
- 56. Hélio Oiticica, *Small Núcleos NC3, NC4, NC6, 1960-1963* [Erre, variations labyrinthiques, Station 8, 2012]**
- 57. Carsten Höller, *Amanite fluorescente*, 2004 [Station 9, 2013]**
- 58. Basserode, *Les naines*, (détails), 2015 [OTTUM #1 - De Mineralis, pierres de visions, 2015]**
- 59. Günther Uecker, *Spirale III*, 1968 [Erre, variations labyrinthiques, Station 8, 2012]**
- 60. Berdaguer & Péjus, *Utopia Bianca*, 2012 [Berdaguer & Péjus : Insula, 2012]**
- 61. Linda Sanchez, *11752 mètres et des poussières...*, 2014 [Station (1)0, 2016]**
- 62. Michel Blazy, *Pierre qui pousse*, 2010-2012 [OTTUM #1 - De Mineralis, pierres de visions, 2015]**

- 63. Vahan Soghomonian, *ORG*, 2015**
[OTTUM #1 – Kata Tjuta, 2015]
- 64. Jason Dodge, *What the living do*, 2016**
[Jason Dodge, *Behind this machine anyone with a mind who cares can enter.*, 2016]
- 65. Charwei Tsai, *Plane Tree Mantra*, 2014**
[Station (1)0, 2016]
- 66. Gianni Colombo, *Spazio Elastico*, 1967-1968** [Laboratoire espace cerveau : retour sur Gianni Colombo et Paul Sharits, 2016]
- 67. FRAME (Alys Demeure, Jérôme Grivel, Héloïse Lauraire, Sandra Lorenzi, Stéphanie Raimondi), *Index*, 2016**
[Station (1)0, 2016]
- 68. Joan Jonas, *Wind*, 1968**
[Station (1)0, 2016]
- 69. Takis, *Electromagnétique III*, 1966**
[Station (1)0, 2016]
- 70. Pierre Huyghe, *Cerro Indio Muerto*, 2016** [Station (1)0, 2016]
- 71. Paul Sharits, *Analytical Studies n°2 : Unframed Lines*, 1976** [Laboratoire espace cerveau : retour sur Gianni Colombo et Paul Sharits, 2016]
- 72. Evariste Richer, *Entre le pôle et l'équateur*, 2011** [Station (1)0, 2016]
- 73. Vahan Soghomonian et Tomi Yard, *FYTOLITE - Fondation en croissance - objets documents et flux*, 2016**
[Station (1)0, 2016]
- 74. James Lee Byars, *The Book of the Hundred Questions*, 1969**
[Station (1)0, 2016]
- 75. Hubert Duprat, *Sans titre*, 2008**
[Station (1)0, 2016]
- 76. Michel Blazy, *Voyage au centre*, 2002-2003** [Station (1)0, 2016]
- 77. Evariste Richer, *Ellipse/Eclipse*, 2007**
[Station (1)0, 2016]
- 78. Abraham Poincheval, *Avant-projet pour marcher sur la canopée nuageuse*, 2016** [Station (1)0, 2016]
- 79. Maarten Vanden Eynde, *Restauration du Lac de Montbel*, 2003-2014** [Station (1)0, 2016]
- 80. Célia Gondol, *Dimensions telluriques*, 2016** [Station (1)0, 2016]
- 81. Hicham Berrada, *Présage*, 2016**
[Station (1)0, 2016]
- 82. Barbara & Michael Leisgen, *Das Licht - der Mensch - die Welt (La Lumière - l'être humain, le monde)*, 1975** [Station (1)0, 2016]
- 83. Otobong Nkanga, *Alterscape*, 2005**
[Station (1)0, 2016]
- 84. Mengzhi Zheng, *Série des maquettes abandonnées, n°15*, 2016** [Station (1)0, 2016]
- 85. James Turrell, *Roden Crater (vue aérienne)*, 1982** [Station (1)0, 2016, documentation]
- 86. Lola González, *Veridis quo (rushes)*, 2016** [Station (1)0, 2016]
- 87. James Whitney, *Lapis*, 1966** [Jardin Infini. De Giverny à l'Amazonie, Station 11, 2017]
- 88. Walter De Maria, *Lightning Field*, 1977**
[Station (1)0, 2016, documentation]
- 89. Carsten Höller, *Giant Triple Mushroom Amanita muscaria / Helvella crispa / Boletus badius*, 2010** [Jardin Infini. De Giverny à l'Amazonie, Station 11, 2017]
- 90. Karl Sims, *Panspermia*, 1990** [Jardin Infini. De Giverny à l'Amazonie, Station 11, 2017]
- 91. Teresa Murak, *Rzeźba dla Ziemi, Ubbeboda Center (Sweden)*, 1974** [Jardin Infini. De Giverny à l'Amazonie, Station 11, 2017]
- 92. João Maria Gusmao et Pedro Paiva,**

Fruit Polyhedron, 2009 [Jardin Infini. De Giverny à l'Amazonie, Station 11, 2017]

93. Kazuo Shiraga, *Challenging Mud*, 1955 [Jardin Infini. De Giverny à l'Amazonie, Station 11, 2017]

94. Ernesto Neto, *Flower Crystal Power (détail)*, 2014 [Jardin Infini. De Giverny à l'Amazonie, Station 11, 2017]

D3

95. Philippe Parreno, *Continuously Habitable Zones aka C.H.Z.*, 2011 [Jardin Infini. De Giverny à l'Amazonie, Station 11, 2017]

96. Tetsumi Kudo, *Le jardin greffé*, 1971 [Jardin Infini. De Giverny à l'Amazonie, Station 11, 2017]

97. Michel François, *L. à la datura*, 1998 [Jardin Infini. De Giverny à l'Amazonie, Station 11, 2017]

98. Giovanni Anselmo, *Trecento milioni di ani*, 1969 [Jardin Infini. De Giverny à l'Amazonie, Station 11, 2017]

99. Claudio Parmiggiani, *Terra*, 1989 [Jardin Infini. De Giverny à l'Amazonie, Station 11, 2017]

100. Ann Veronica Janssens, *Untitled (Blue Glitter)*, 2015 [Ann Veronica Janssens : mars, 2017]

D4

101. Jef Geys, *Quadra Medicinale*, 2009 [Jef Geys : Les Plantes Médicinales, 2017]

102. Ann Veronica Janssens, *Muhka, Anvers*, 1997 [Ann Veronica Janssens : mars, 2017]

103. Masanobu Fukuoka, *La révolution d'un seul brin de paille*, 1981 [Station 12, 2017]

104. Marina Abramovic & Ulay, *The Lovers*, 1988 [Station 12, 2017, documentation]

105. Maria Thereza Alves, *Chanson Florale*, 2018 [Maria Thereza Alves, Jimmie Durham : The Middle Earth, Station flash, 2018]

106. Lee Mingwei, *When Beauty Visits*, 2017 [Station 12, 2017, documentation]

107. Maria Loboda, *To Separate the Sacred From the Profane*, [Séparer le sacré du profane], 2016 [Maria Loboda : La Fête, La Musique, La Noce, 2018]

108. Pratchaya Phinthong, *All is Dust*, 2011 [Station 12, 2017, documentation]

109. Agnes Denes, *Rice/Tree/Burial with Time Capsule*, 1977-2017 [Station 12, 2017]

110. Maria Lai, *Legarsi alla montagna*, 1981 [Station 12, 2017, documentation]

111. Damien Faure, *Milieu*, 2015 [Station 12, 2017]

112. Ann Veronica Janssens, *Untitled (Prism)*, 2013 [Ann Veronica Janssens : mars, 2017]

113. Robin Meier & Ali Momeni, *The Tragedy of the Commons*, 2011 [Station 13, 2018]

114. Adrian Piper, *YOU-STOP-WATCH. A Shiva Japan*, 2002-2017 [Station 12, 2017]

115. Robert Filliou, *Eins. Un. One...*, 1984 [Station 12, 2017, documentation]

116. José Corti, *Rêves d'encre : Vingt-cinq images présentées par Paul Eluard, René Char, Julien Gracq et Gaston Bachelard*. Paris : José Corti, 1945 [Station 12, 2017, documentation]

117. Daniel Steegmann Mangrané, *Phasmides*, 2008-2012 [Station 13, 2018]

118. Charwei Tsai, *Ah !*, 2011 [Station 12, 2017, documentation]

119. Dove Allouche, *Désublimation 33*, 2016 [Collection à l'étude - Chaomose, 2018-2019]

120. Linda Sanchez, *La détente II*, 2018
[OTIUM #3 - Linda Sanchez, 2018]

121. Hubert Duprat, *Sept tubes de trichoptères*, 1980-1997 [Station 13, 2018]

122. Michihiro Shimabuku, *Then, I decided to give a tour to the octopus from Akashi*, 2000 [Station 13, 2018]

123. Célia Gondol, *Observables d'Apeiron (détail)*, 2016 [Collection à l'étude - Chaosmose, 2018-2019]

124. Tomás Saraceno, *Webs of At-tent(s)ion*, 2018 [Station 13, 2018]

125. Liu Dan, *Blue Rock*, non datée
[Station 12, 2017, documentation]

126. Anicka Yi, *Force Majeure*, 2017
[Station 14, 2019, documentation]

127. Dane Mitchell, *Aeromancy (Sketches of Meteorological Phenomena)*, 2014-2017
[OTIUM #3 - Dane Mitchell, 2018]

128. Hicham Berrada, *Masse et martyr*, 2017 [Station 14, 2019]

129. Pedro Neves Marques, *YWY, a androïde [YWY, the Android]*, 2017
[Station 15, 2019]

130. Sarah del Pino, *Rêvent-elles de robot astronautes ?*, 2017 [Station 13, 2018]

131. Pierre Huyghe, *After ALife Ahead*, 2017 [Station 14, 2019, documentation]

132. Isabelle Andriessen, *Plastic Coma (sweat)*, 2017 [Station 14, 2019, documentation]

133. Katinka Bock, *Sand*, 2018 [Katinka Bock: Radio / Tomorrow's Sculpture, 2018-2019]

134. Nina Canell, *Gum Shelf*, 2017
[Station 14, 2019, documentation]

135. Daniel Steegmann Mangrané, 2019
[Daniel Steegmann Mangrané : Ne voulais prendre ni forme, ni chair, ni matière, 2019]

136. Nicolas Momein, *Crin*, 2014
[De l'immersion à l'osmose, Chaosmose #2, 2019]

137. Daniel Steegmann Mangrané, *Spiral Forest (Kingdom of All the Animals And All the Beasts Is My Name)*, 2013-2015
[Station 15, 2019]

138. Leone Contini, *Banque de graines migrantes*, 2019 [OTIUM #4 - Leone Contini, 2019]

139. Pierre Huyghe, *Untitled (Human Mask)*, 2014 [Station 15, 2019]

140. Michel Blazy, *Voyage au centre/ Green Paper Gate/Le multivers*, 2003 [De l'immersion à l'osmose, Chaosmose #2, 2019]

141. Ann Veronica Janssens, *Spray 2*, 2011, *Spray 3*, 2012 2014 [De l'immersion à l'osmose, Chaosmose #2, 2019]

142. Daniel Steegmann Mangrané, 2019
[Daniel Steegmann Mangrané : Ne voulais prendre ni forme, ni chair, ni matière, 2019]

143. Giuseppe Penone, *Propagazione (détail)*, 1995 [De l'immersion à l'osmose, Chaosmose #2, 2019]

144. Hicham Berrada, *Présage 04/10/2014, 22h09 / Présage 04/10/2014, 01h22*, 2007-2014 [De l'immersion à l'osmose, Chaosmose #2, 2019]

145. Kate Newby, *Wild was the night*, 2019
[OTIUM #4 - Kate Newby, 2019]

146. Ana Mendieta, *Burial Pyramid*, 1974
[De l'immersion à l'osmose, Chaosmose #2, 2019]

147. Maria Laet, *Earth (Canudos)*, 2015
[OTIUM #4 - Maria Laet, 2019]

Photo credits

Erre, variations labyrinthiques, exhibition at Centre Pompidou-Metz from the 12th of September 2011 to the 5th of March of 2012
© Rémi Villaggi (50 ; 55 ; 59)

Jardin Infini. De Giverny à l'Amazonie, exhibition at Centre Pompidou-Metz from 18 March to 5 August 2017
© Tony Prikryl (94 ; 98)

For all other exhibition's colored views
© André Morin (5)
© Blaise Adilon

INFORMATION

→ <http://laboratoireespacecerveau.eu>

→ Mise en espace du Laboratoire :
Mengzhi Zheng

Contacts

Nathalie Ergino
Curator

Pauline Créteur
Researcher
laboratoire@i-ac.eu

Elli Humbert
Production manager / assistant curator
assisted of Marine Rousset
+ 33(0)4 78 03 47 02
e.humbert@i-ac.eu

Corinne Guerci
Publishing and documentation
assisted of Caroline Le Saux
T/ +33 (0)4 78 03 47 08
c.guerci@i-ac.eu

In partnership with **Arte Distribution**
and with **Radio France/France Culture**

→ This document can be downloaded on
our website : www.i-ac.eu



arte
DISTRIBUTION

